

### Accessori Accessories



- ① Testa di carico / Loading head
- ② Piastra base / Mounting plate



- ③ Unità di pesatura  
Weighing unit

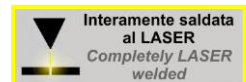
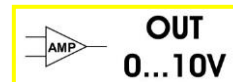
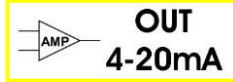
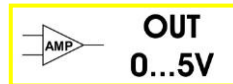
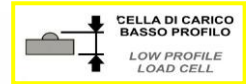

### Dimensioni Dimensions

[mm]



LOAD	A	B	C	ØD	ØE	ØF	ØG	H	I	M	n°M	R	ØS	T	U
from 100 kg to 10 t	32	12	11	82	22	68	52.3	44	102	M8	3	50	60	0.3	6
20 t - 30 t	50	14	12	126	35	90	77.3	64	148	M8	3	160	93	0.5	15
50 t - 75 t - 100 t	60	20	20	165	60	130	92.3	80	188	M16	4	300	115	1	17
150 t - 200 t	80	30	20	200	80	152	107	110	223	M16	4	300	128	1	23

LOAD	CODE
100 kg	CC2S82100KC15
250 kg	CC2S82250KC15
500 kg	CC2S82500KC15
1 t	CC2S821TC15
2.5 t	CC2S822T5C15
5 t	CC2S825TC15
7.5 t	CC2S827T5C15
10 t	CC2S8210TC15
20 t	CC2S12620TC15H
30 t	CC2S12630TC15H
50 t	CC2S16550TC15
75 t	CC2S16575TC15
100 t	CC2S165100TC15
150 t	CC2S200150TC15
200 t	CC2S200200TC15

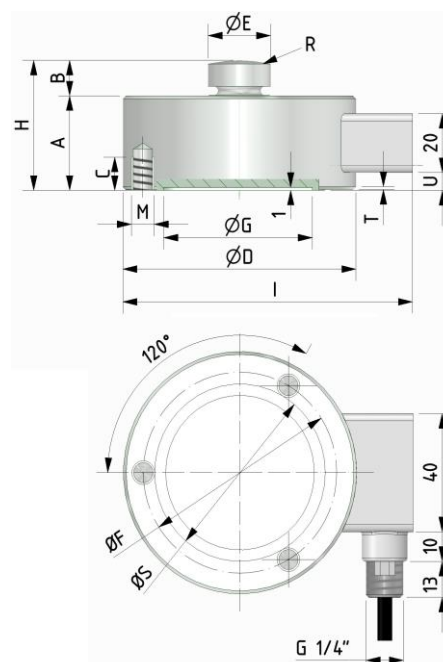

**Dimensioni ACCESSORI**      **ACCESSORIES dimension**      [mm]      **A**

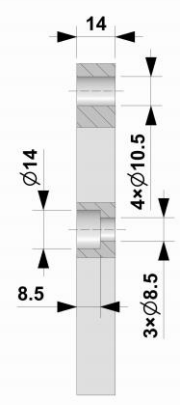
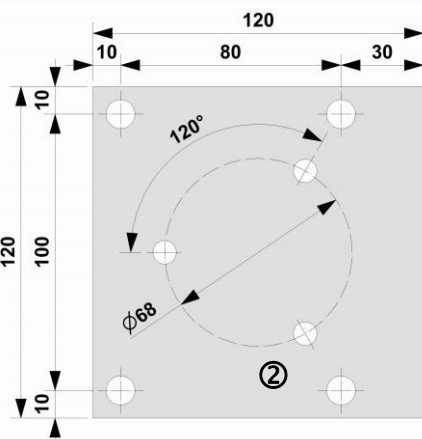
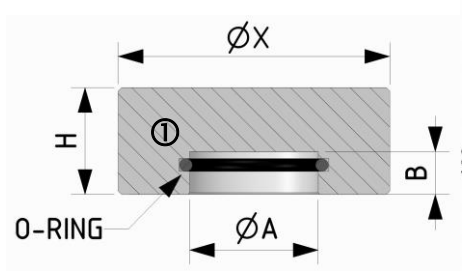
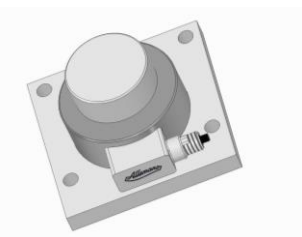
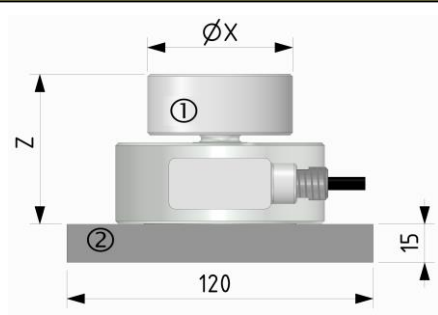

C2S	CODE		ACCESSORIES	ACCESSORI	Z	ØX	ØA	B	H
100, 250, 500 kg 1, 2.5, 5, 7.5, 10 t	CTIC22	①	Loading head	Testa di carico	59	57	23	9	24
	CPB120D82	②	Mounting plate	Piastra base	/	/	/	/	/
	CUPC2	③	Weighing unit	Unità di pesatura	/	/	/	/	/
20, 30 t	CTIC35	①	Loading head	Testa di carico	82	76	36	12	30
	CUPC3	③	Weighing unit	Unità di pesatura	/	/	/	/	/
50, 75, 100 t	CTIC60	①	Loading head	Testa di carico	106	126	61	12	38
	CUPC5	③	Weighing unit	Unità di pesatura	/	/	/	/	/
150, 200 t	CTIC80	①	Loading head	Testa di carico	157	128	81	21	68

**Esempi d'installazione**      **Examples of installation**

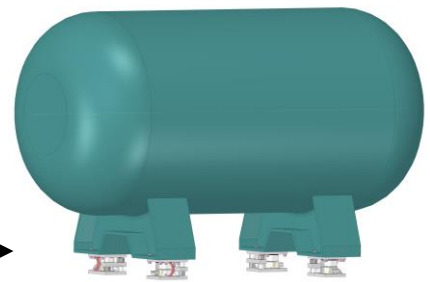
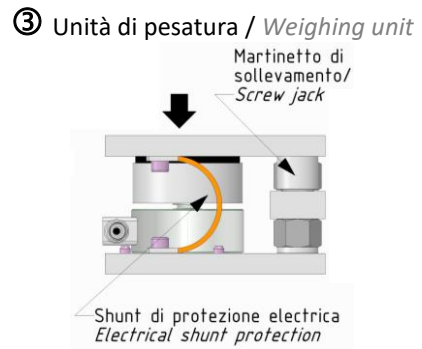
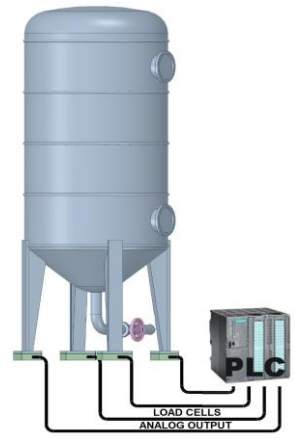
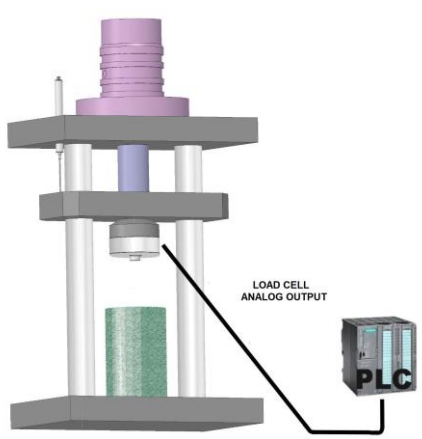

Sistema di pesatura serbatoio a 4 punti di appoggio  
Weighing system for tank with 4 supporting points.

**Dati Tecnici**
**Technical Data**

ACCURATEZZA	ACCURACY	<b>0.03 %</b>			
CARICO NOMINALE ( $E_{max}$ )	NOMINAL LOAD ( $E_{max}$ )	100 – 250 – 500 kg 1 – 2.5 – 5 – 7.5 – 10 – 20 t 30 – 50 – 75 – 100 – 150 – 200 t			
SENSIBILITA' NOMINALE TOLLERANZA DI CALIBRAZIONE	NOMINAL SENSITIVITY CALIBRATION TOLERANCE	<b>4-20 mA (3 wires), 0...5 V or 0...10 V</b> < $\pm 0.1 %$			
NON LINEARITA' NON RIPETIBILITA'	NON LINEARITY NON REPEATABILITY	$\leq \pm 0.03 %$ $\leq \pm 0.01 %$			
EFFETTO DELLA TEMPERATURA (10 °C) a) sullo zero b) sulla sensibilità	TEMPERATURE EFFECT (10 °C) a) on zero b) on sensitivity	$\leq \pm 0.024 %$ $\leq \pm 0.017 %$			
ALIMENTAZIONE NOMINALE	NOMINAL POWER SUPPLY	4-20 mA and 0...5 V → 12 ... 24 Vdc 0...10 V → 18 ... 24 Vdc			
ALIMENTAZIONE MAX. ASSORBIMENTO MAX. (senza carico applicato): RESISTENZA DI CARICO: a) tensione b) corrente RESISTENZA DI ISOLAMENTO BILANCIAMENTO DI ZERO FREQUENZA DI RISPOSTA	MAX. POWER SUPPLY MAX. ABSORPTION (without load applied) LOADING RESISTANCE: a) tension b) current INSULATION RESISTANCE ZERO BALANCE RESPONSE FREQUENCY	28 Vdc  30 mA  min. 3 K $\Omega$ from 0 to 470 $\Omega$ > 2 G $\Omega$ $\pm 1 %$ ~ 1 kHz			
VALORI MECCANICI LIMITE riferiti al carico nominale: a) carico minimo b) carico di servizio c) carico limite d) carico di rottura e) massimo carico trasversale f) carico dinamico limite	MECHANICAL LIMIT values referred to nominal load: a) minimum load b) service load c) max permissible load d) breaking load e) max transverse load f) max permissible dynamic load	0 % 120 % 150 % >300 % 50 % 50 %			
CARICO NOMINALE	NOMINAL LOAD	100 kg ... 10 t	20 t 30 t	50 t 100 t	150 t 200 t
FRECCIA MAX. AL CARICO NOMINALE	DISPLACEMENT AT NOMINAL LOAD	~0.06mm	~0.16mm	~0.23mm	~0.36mm
TEMPERATURA DI RIFERIMENTO CAMPO NOMINALE DI TEMP. TEMPERATURA DI ESERCIZIO TEMPERATURA DI STOCCAGGIO	REFERENCE TEMPERATURE TEMPERATURE NOMINAL RANGE SERVICE TEMPERATURE STORAGE TEMPERATURE	+23 °C -10 / +40 °C -20 / +70 °C -20 / +80 °C			
PESO	WEIGHT	~1.3 kg	~3.4 kg	~9.4 kg	~18.2 kg
CLASSE DI PROTEZIONE (EN 60529) MATERIALE DELLA CELLA LUNGHEZZA CAVO	PROTECTION CLASS (EN 60529) EXECUTION MATERIAL CABLE LENGTH	IP68 (100h at 1m water column) Acciaio Inox / Stainless Steel 5 m (on request 10 m)			
VITI DI FISSAGGIO: a) diametro b) classe di resistenza c) coppia di serraggio	FIXING SCREWS a) diameter b) resistance class c) tightening torque	M8 12.9 80 Nm	M8 12.9 80 Nm	M16 12.9 230 Nm	M16 12.9 230 Nm

Accelerazione di gravità  $g=9.80434 \text{ m/s}^2$  / Acceleration of gravity  $g=9.80434 \text{ m/s}^2$ .



## OPZIONI

Da acquistare separatamente

## OPTIONS

To be purchased separately

	CODE	(1) OPZIONE	(1) OPTION
	<b>CMIL6MF</b>	Uscita diretta connettore <b>MIL6M</b>	<i>Direct output connector <b>MIL6M</b></i>
	<b>CMIL6FV5</b>	CONNETTORE <b>MIL6M</b> femmina 6 poli dritto completo di <b>CAVO</b> PVC schermato lunghezza 5 m.	<i>Female 6 poles straight <b>MIL6M</b> CONNECTOR complete PVC <b>CABLE</b>, shielded, length 5 m.</i>

	CODE	(2) OPZIONE	(2) OPTION
	<b>CONNM12MF</b>	Uscita diretta connettore <b>M12</b>	<i>Direct output connector <b>M12</b></i>
	<b>CONNM12FV5</b>	CONNETTORE <b>M12x1</b> femmina 5 poli dritto completo di <b>CAVO</b> PVC costampato schermato lunghezza 3 m.	<i>Female 5 poles straight <b>M12x1</b> CONNECTOR complete PVC molded <b>CABLE</b>, shielded, length 3 m.</i>

## Collegamenti Elettrici *Electrical Connections*

**USCITA STANDARD:** cavo schermato PVC 105°C, Ø 5.2 mm a 4x Ø 0.35mm<sup>2</sup> conduttori stagnati.  
**STANDARD OUTPUT:** PVC 105°C shielded cable, Ø 5.2mm with 4x Ø 0.35mm<sup>2</sup> tinned conductors.

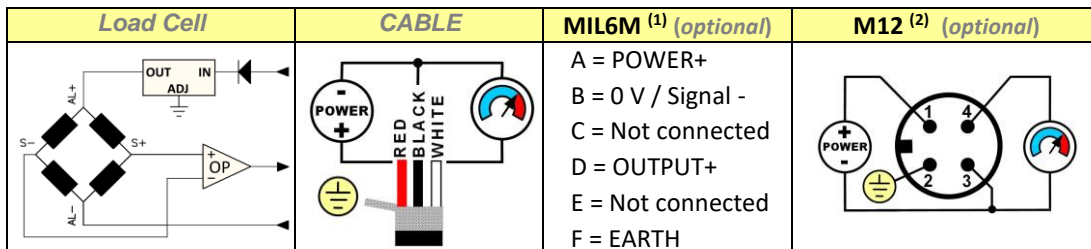

Schermo collegato al corpo del trasduttore.  
*Shield connected to the body of the transducer.*



**NUOVA ALLEMANO S.r.l.**  
 Via Giacomo Leopardi 13 – 10095 Grugliasco – Torino – Italy  
 Tel. (+39) 0112734400 - Fax (+39) 0112732888  
 e-mail: [info@allemano.it](mailto:info@allemano.it) sito: [www.allemano.it](http://www.allemano.it)

Al fine di migliorare le prestazioni tecniche del prodotto, la società si riserva di apportare variazioni senza preavviso.  
*In order to improve the technical performances of the product, the company reserves the right to make any dynamometer without notice.*